

vtech[®]
Baby

User's Manual

TooT-Too Drivers[®] Traffic Tracks

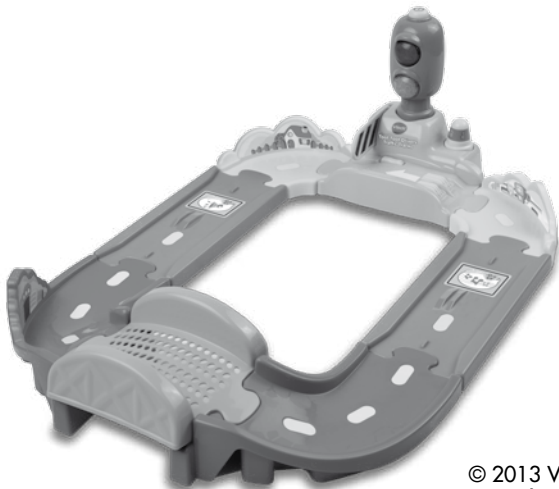

© 2013 VTech
Printed in China
91-002686-009 (UK)

VTech understands that a child's needs and abilities change as they grow and with that in mind we develop our toys to teach and entertain at just the right level...

vtech Baby

Toys that will stimulate their interest in different textures, sounds and colours

I am...

...responding to colours, sounds and textures

...understanding cause and effect

...learning to touch, reach, grasp, sit-up, crawl and toddle

Birth-36 months



Pre-School

Interactive toys to develop their imagination and encourage language development

I want...

...to get ready for school by starting to learn the alphabet and counting

...my learning to be as fun, easy and exciting as can be

...to show my creativity with drawing and music so my whole brain develops

3-6 years



Electronic Learning Computers

Cool, aspirational and inspiring computers for curriculum related learning

I need...

...challenging activities that can keep pace with my growing mind

...intelligent technology that adapts to my level of learning

...National Curriculum based content to support what I'm learning at school

4-10 years



To learn more about this and other VTech® products, visit www.vtechuk.com

INTRODUCTION

Thank you for purchasing the **VTech® Toot-Toot Drivers Traffic Tracks** learning toy!

Drive along for learning fun with the **Toot-Toot Drivers Traffic Tracks**. Drive your vehicle around the tracks, stopping at the traffic gate if the light is red, if it's green you can drive along! Drive over the SmartPoints to hear fun phrases, sound effects and songs. The Traffic Tracks also recognise all the Toot-Toot Drivers vehicles (Sold separately).

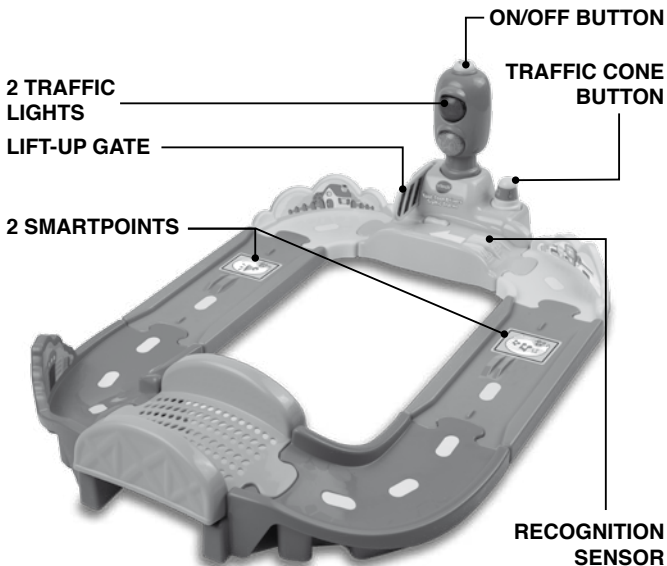

INCLUDED IN THIS PACKAGE

- One VTech® Toot-Toot Drivers Traffic Tracks

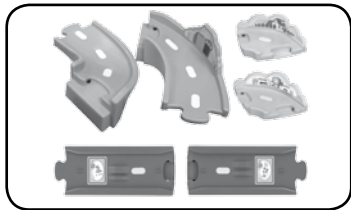

6 road pieces



1 bridge



1 traffic light

- One instruction manual

WARNING: All packing materials, such as tape, plastic sheets, packaging locks and tags are not part of this toy, and should be discarded for your child's safety.

NOTE: Please keep this instruction manual as it contains important information.

Unlock the packing lockers:

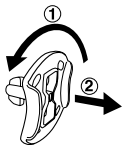

① Rotate the packing locker anti-clockwise

② Pull out the packing locker and discard

GETTING STARTED

BATTERY INSTALLATION

1. Make sure the unit is turned **OFF**.
2. Locate the battery cover on the bottom of the Toot-Toot Drivers Traffic Tracks. Use a coin or a screwdriver to loosen the screw.
3. Install 2 new AA (LR6/AM-3) batteries following the diagram inside the battery box. (The use of new alkaline batteries is recommended for maximum performance.)
4. Replace the battery cover and tighten the screw to secure.

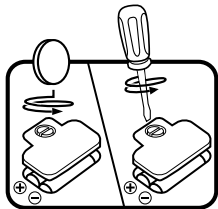

BATTERY NOTICE

- Use new alkaline batteries for maximum performance.
- Use only batteries of the same or equivalent type as recommended.
- Do not mix different types of batteries: alkaline, standard (carbon-zinc) or rechargeable (Ni-Cd, Ni-MH), or new and used batteries.
- Do not use damaged batteries.
- Insert batteries with the correct polarity.
- Do not short-circuit the battery terminals.
- Remove exhausted batteries from the toy.
- Remove batteries during long periods of non-use.
- Do not dispose of batteries in fire.
- Do not charge non-rechargeable batteries.
- Remove rechargeable batteries from the toy before charging (if removable).
- Rechargeable batteries are only to be charged under adult supervision.

Disposal of batteries and product



The crossed-out wheellie bin symbols on products and batteries, or on their respective packaging, indicates they must not be disposed of in domestic waste as they contain substances that can be damaging to the environment and human health.



The chemical symbols Hg, Cd or Pb, where marked, indicate that the battery contains more than the specified value of mercury (Hg), cadmium (Cd) or lead (Pb) set out in Battery Directive (2006/66/EC).

The solid bar indicates that the product was placed on the market after 13th August, 2005.

Help protect the environment by disposing of your product or batteries responsibly.

For more information, please visit:

www.recycle-more.co.uk

www.recyclenow.com

PRODUCT FEATURES

1. ON/OFF BUTTON

To turn the unit **ON** or **OFF**, press the **ON/OFF** button.



2. TURNING LIGHTS

The traffic lights can be turned 180 degrees, you will hear a click sound when it is turned to the correct position.

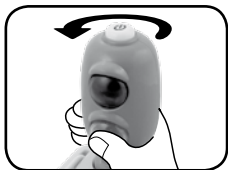

3. SMARTPOINT

Two SmartPoint track locations recognise Toot-Toot Drivers vehicles (SmartPoint vehicles only. Each sold separately.) to teach early language skills.

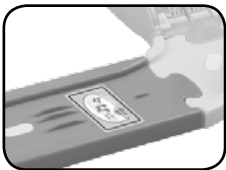

4. AUTOMATIC SHUT-OFF

To preserve battery life, the **VTech® Toot-Toot Drivers Traffic Tracks** will automatically power-down after approximately 45 seconds without input. The unit can be turned on again by pressing any button except when pressing the recognition sensors.

ACTIVITIES

1. Press the **ON/OFF** button. You will hear a fun sing-along song. The lights will flash with the sounds.
2. Press the Red or Green light-up buttons to learn colours and traffic facts. The lights will flash with the sounds.
3. Press the Traffic cone press button and you will hear lovely sing-along songs and fun melodies. The lights will flash with the sounds.

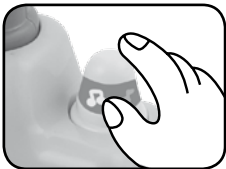

4. Flip the gate to hear driving phrases and sounds. The lights will flash with the sounds.



5. Push a vehicle (not included) quickly over the recognition sensor pad or press the button to hear fun sounds and short tunes. The lights will flash with the sounds.

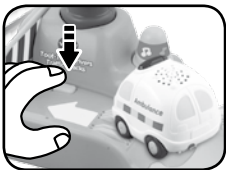

6. Push a vehicle (not included) slowly through the recognition sensor pad, to hear a fun greeting specific to the vehicle or a short tune. The lights will flash with the sounds. (Vehicle must be facing the same direction as the arrow)



7. Push a vehicle over a SmartPoint™ to hear the vehicle say a related phrase or play a sound effect. (SmartPoint vehicles only)



8. If there is no input to the unit after approximately 4 seconds, you will hear a friendly voice. If there is still no input after another 4 seconds, you will hear another friendly voice. If there is still no input after 4 seconds, you will hear another sing-along song. If there is still no input after a further 4 seconds, then the unit will automatically power down.

MELODY LIST

1. The Wheels on the Bus
2. I've Been Working on the Railroad
3. London Bridge
4. Row, Row, Row your Boat
5. Skip to My Lou
6. Old King Cole
7. Jack & Jill
8. Hot Cross Buns
9. She'll Be Coming 'Round the Mountain

SUNG SONG LYRICS

Driving on the road
Travelling on our way
Obey the traffic lights
Drive over the bridge
Cruise around all day!

CARE & MAINTENANCE

1. Keep the unit clean by wiping it with a slightly damp cloth.
2. Keep the unit out of direct sunlight and away from any direct heat source.
3. Remove the batteries when the unit will not be in use for an extended period of time.
4. Do not drop the unit on hard surfaces and do not expose the unit to moisture or water.

TROUBLESHOOTING

If for some reason the program/activity stops working or malfunctions, please follow these steps:

1. Please turn the unit OFF.
2. Interrupt the power supply by removing the batteries.
3. Let the unit stand for a few minutes, then replace the batteries.
4. Turn the unit ON. The unit should now be ready to play again.
5. If the product still does not work, replace with an entire set of new batteries.

If the problem persists, please call our Consumer Services Department on 01235 546810 (from UK) or +44 1235 546810 (outside UK) and a service representative will be happy to help you.

IMPORTANT NOTE:

Creating and developing **VTech®** products is accompanied by a responsibility that we take very seriously. We make every effort to ensure the accuracy of the information, which forms the value of our products. However, errors sometimes can occur. It is important for you to know that we stand behind our products and encourage you to call our Consumer Services Department on 01235 546810 (from UK) or +44 1235 546810 (outside UK), with any problems and/or suggestions that you might have. A service representative will be happy to help you.

**CLASS 1
LED PRODUCT**



PRODUCT WARRANTY



Thank you for choosing this quality product from VTech. We hope it will bring many hours of entertainment, imaginative play and learning.

1. The product detailed above is covered by a one year warranty from the date of purchase, against any defects in materials or workmanship.
2. The product may be returned to the place of purchase. Alternatively the product can be returned to VTech Electronics Europe plc (see address below), with proof of purchase, without proof of purchase no replacement will be provided.
3. VTech Electronics Europe plc will examine the product and if it is found to be defective due to faulty materials or workmanship, will replace the product at their discretion.
4. If the product covered by this warranty is damaged due to misuse, modification or unauthorised repair, or because of faulty batteries, battery discharge or incorrect electrical connections, then this warranty becomes void.
5. This warranty is personal to the original purchaser and is not transferable.
6. Breakages to the LCD screen are not covered by the warranty.
7. Returns to VTech Electronics Europe plc should include a cheque or postal order for £1.50 towards the cost of return postage and packaging.
8. Products returned to VTech Electronics Europe plc, should be addressed as follows and packed carefully to avoid damage in transit (Please do not include batteries or adaptor).
Please include details of the fault together with your name and address.

VTech Electronics Europe plc, c/o Tablogix Limited, 200 Milton Park, Abingdon, Oxon OX14 4TA

THIS WARRANTY IS OFFERED AS AN EXTRA BENEFIT AND DOES NOT AFFECT CONSUMERS' STATUTORY RIGHTS.

This warranty is valid for the UK and Eire only. For products purchased outside the UK and Eire, please contact your local distributor or place of purchase.

